

AR-15 PARTS LIST

(flip over for coordinating part name)



20900 W. Ireland Rd.

South Bend, IN 46614

Ph. 1.800.366.3682

Fax.574.299.8044

info@cleansealsprings.com

www.cleansealsprings.com

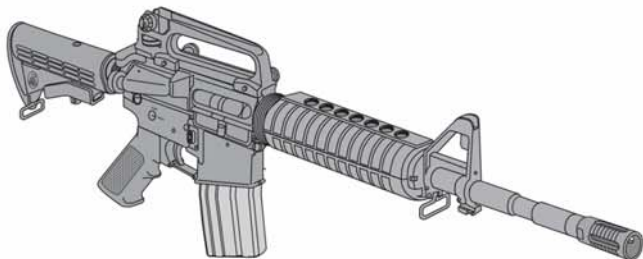
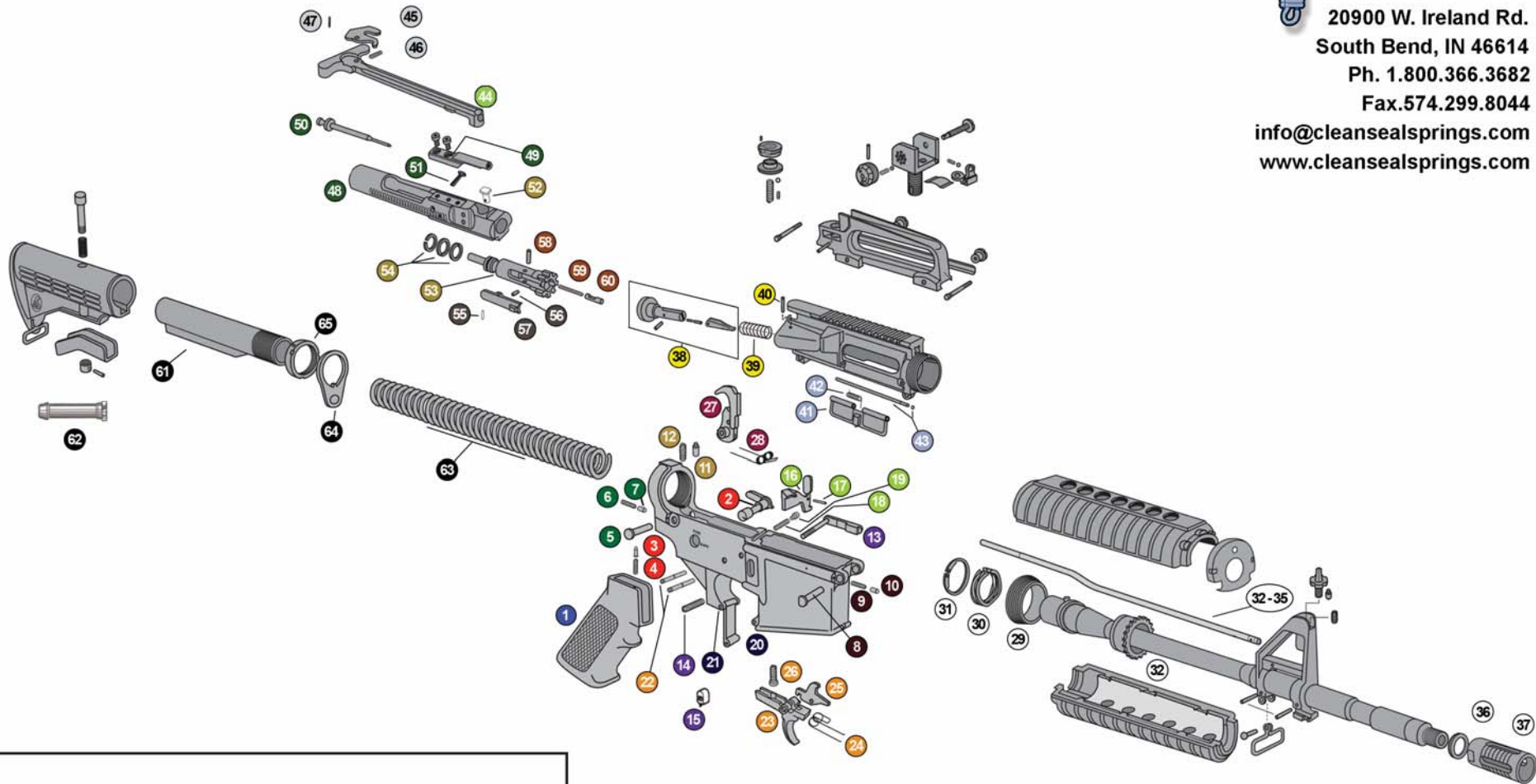

AR Lower Assembly		
Pistol Grip	1	ZMC-GS2-1
Selector Switch	2	ZMC-GS2-2
Selector Detent	3	ZMC-GS2-3
Selector Detent Spring	4	ZMC-GS-14
Takedown Pin (Rear)	5	ZMC-GS-12
Takedown Pin Detent Spring (Rear)	6	ZMC-GS-09
Takedown Pin Detent (Rear)	7	ZMC-GS-08
Pivot Pin (Front)	8	ZMC-GS-13
Pivot Pin Detent Spring (Front)	9	ZMC-GS2-9
Pivot Pin Detent (Front)	10	ZMC-GS2-10
Buffer Retainer Pin	11	ZMC-GS2-11
Buffer Retainer Spring	12	ZMC-GS-05
Magazine Catch	13	ZMC-GS2-13
Magazine Catch Spring	14	ZMC-GS-10
Magazine Catch Button	15	ZMC-GS2-15
Bolt Catch	16	ZMC-GS2-16
Bolt Catch Spiral Pin	17	ZMC-GS2-17
Bolt Catch Plunger Spring	18	ZMC-GS2-18
Bolt Catch Plunger	19	ZMC-GS2-19
Hammer & Trigger Assembly		
Trigger Guard	20	ZMC-GS2-20
Trigger Guard Spring Pin	21	ZMC-GS2-21
Hammer/Trigger Pin (x2)	22	ZMC-GS-11
Trigger 5.56/.223	23	ZMC-GS2-23
Trigger Spring	24	ZMC-GS2-24
Disconnecter AR	25	ZMC-GS2-25
Disconnecter Spring AR	26	ZMC-GS2-26
Hammer w "J" Pin 100013	27	ZMC-GS2-27
Hammer Spring	28	ZMC-GS2-28

Barrel Assembly		
Delta Ring	29	ZMC-GS2-29
Weld/Wave Spring	30	ZMC-GS-02
Snap Ring	31	ZMC-GS2-31
Barrel Nut	32	ZMC-GS2-32
Gas Tube, Carbine Length	33	ZMC-GS2-33
Gas Tube, Mid Length	34	ZMC-GS2-34
Gas Tube, Rifle Length	35	ZMC-GS2-35
Crush Washer	36	ZMC-GS2-36
Flash Hider A2	37	ZMC-GS2-37

Miscellaneous			
QD Swivel 1. 1/4 "	ZMC-GS-01-1.25	30 RD Magazine Spring Stainless	ZMC-GS2-S30RDM
QD Swivel 1"	ZMC-GS2-QD-1.0	30 Rd Magazine Spring Chrome Sil	ZMC-GS2-C30RDM
QD Swivel Small D	ZMC-GS2-QD-SD	10 RD Magazine Spring Stainless	ZMC-GS2-S10RDM
QD Swivel Large D	ZMC-GS2-QD-LD	10 Rd Magazine Spring Chrome Sil	ZMC-GS2-C10RDM

AR Upper Assembly		
Forward Assist Assembly	38	ZMC-GS2-38
Forward Assist Spring	39	ZMC-SS00070
Forward Assist Spring Pin	40	ZMC-GS2-40
Ejection Port Cover	41	ZMC-GS2-41
Ejection Port Cover Spring	42	ZMC-GS-18
Ejection Port Cover Rod	43	ZMC-GS2-43
Charging Handle	44	ZMC-GS2-44
Charging Handle Latch	45	ZMC-GS2-45
Charging Handle Spring	46	ZMC-GS2-46
Charging Handle Spring Pin	47	ZMC-GS2-47

Bolt Carrier Assembly		
Bolt Carrier Assembly w/o Gas Key	48	ZMC-GS2-48
Gas Key w 2 Screws	49	ZMC-GS2-49
Firing Pin	50	ZMC-GS2-50
Firing Pin Retaining Pin	51	ZMC-GS2-51
Bolt Cam Pin	52	ZMC-GS2-52
Bolt	53	ZMC-GS2-53
Bolt Gas Ring x3	54	ZMC-GS-17
Extractor Spiral Pin	55	ZMC-GS2-55
Extractor Spring	56	ZMC-GS2-56
Extractor Arm	57	ZMC-GS2-57
Ejector Spiral Pin	58	ZMC-GS2-58
Ejector Spring	59	ZMC-GS-14
Ejector Cartridge	60	ZMC-GS2-60

Stock Assembly		
Buffer Tube	61	ZMC-SS00134
Buffer Carbine	62	ZMC-GS2-62
Buffer Spring Carb.223/5.56 Stainless	63	ZMC-GS-19
Buffer Spring Carb.223/5.56 Chrome Sil	63	ZMC-GS2-63.C223C
Buffer Spring Carb.308 Chrome Sil	63	ZMC-GS2-63.C308C
Buffer Spring Rifle.223/5.56 Stainless	63	ZMC-GS2-63.R223S
Buffer Spring Rifle.223/5.56 Chrome Sil	63	ZMC-GS2-63.R223C
Buffer Spring Rifle 308 Stainless	63	ZMC-GS2-63.R308S
End Plate	64	ZMC-GS-64
Castle Nut	65	ZMC-GS-65